

## 7122 West Charles Page Blvd.

\$1,200,000 or \$4.00/sq. ft.

**FOR SALE OR LEASE**

- Building #1: 2 story 5400 sq. ft., offices
- #2: 1024 sq. ft. house is office
- #3: Tall warehouse 2-16 ft. doors, 2 ton crane, 7200 sq. ft., heated
- #4: Low warehouse 2-14 ft. doors, free span with heat
- #5: Long 9000 sq. ft. warehouse, 8ft. ceiling & 4 electric meters



**Property zoning:** Moderate  
**Tax rate:** 2B Sand Springs  
**Taxes:** 2017 \$9,620.00  
**Acres:** 7.58

**Subdivision**  
**Tulsa County:**

Unplatted  
Part of Section 7  
Township 19 N.  
Range 12 East

**Improvements:** 5 buildings  
**220 Electric:** Buildings 3&4  
**Restrooms:** Buildings 1-5  
**2 Small buildings:** Shed type

**Rodney Linsenmeyer, Broker**  
**918-694-3928**

[rod@linsenmeyerrealty.com](mailto:rod@linsenmeyerrealty.com)

BLDG #2



BLDG #4

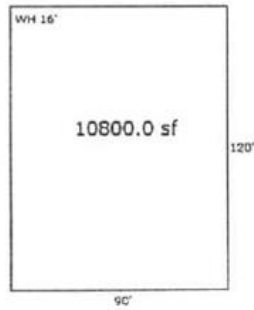

BLDG #3

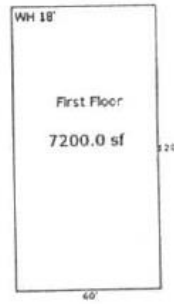

BLDG. #5

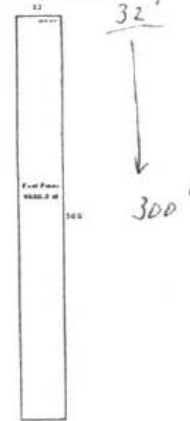

7200 W CHARLES PAGE BLVD  
BLDG #1

